



Horizontal Bottle Coolers

Service / Warranty: 888-828-5535

BERBC50



BERBC65



BERBC80



BERBC95



MODELS: BERBC50
BERBC65
BERBC80
BERBC95

FEATURES:

- ☑ Stainless steel exterior & interior
- ☑ Dixell digital controller
- ☑ Maintains temperatures between 33°F – 40°F
- ☑ Heavy duty Embraco compressor with environmentally friendly R290 refrigerant.
- ☑ Slide out compressor assembly for easy maintenance
- ☑ Easy glide stainless steel lid(s) with handle(s)
- ☑ Lid lock(s) standard
- ☑ Bottle opener & cap catcher standard
- ☑ Wire dividers standard
- ☑ Pre-installed casters

DIMENSIONS:

	Width	Depth	Height	Net Weight
BERBC50	49 ^{3/8}	x 27 ^{4/5}	x 36 ^{5/8}	176 lbs
BERBC65	64 ^{3/4}	x 27 ^{4/5}	x 36 ^{5/8}	205 lbs
BERBC80	80 ^{1/2}	x 27 ^{4/5}	x 36 ^{5/8}	251 lbs
BERBC95	95 ^{3/10}	x 27 ^{4/5}	x 36 ^{5/8}	282 lbs

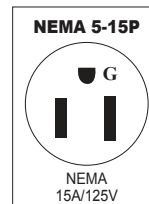



Horizontal Bottle Coolers

Service / Warranty: 888-828-5535

SPECIFICATIONS

Model	Doors	Cu.Ft	Wire Dividers	Exterior Dimension	Packaging Dimension	Casters	Crated Weight	HP	Voltage	Amps	Refrigerant
BERBC50	2	11.7	3	49 ^{3/8} x 27 ^{4/5} x 36 ^{5/8}	51 x 29.1 x 40.2	2.5 in.	236 lbs	1/6	115/60/1	2.3	R290
BERBC65	2	16.4	4	64 ^{3/4} x 27 ^{4/5} x 36 ^{5/8}	66.3 x 29.1 x 40.2	2.5 in.	278 lbs	1/6	115/60/1	2.3	R290
BERBC80	3	21.2	5	80 ^{1/2} x 27 ^{4/5} x 36 ^{5/8}	82.1 x 29.1 x 40.2	2.5 in.	344 lbs	1/5	115/60/1	2.8	R290
BERBC95	3	25.8	6	95 ^{3/10} x 27 ^{4/5} x 36 ^{5/8}	96.9 x 29.1 x 40.2	2 in.	392 lbs	1/5	115/60/1	2.8	R290

LINE DRAWINGS

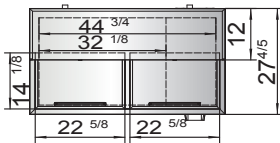

BERBC50

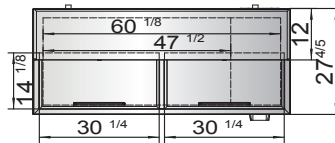

BERBC65

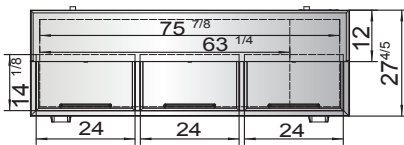
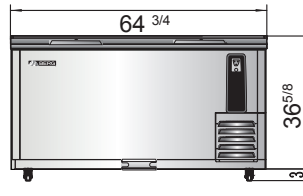
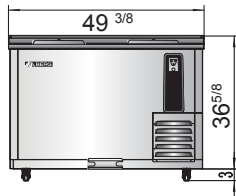
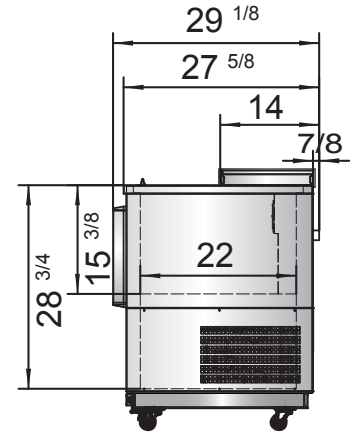

BERBC80

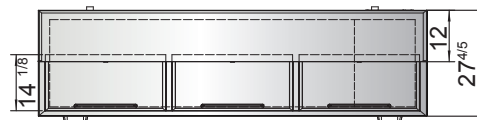

BERBC95

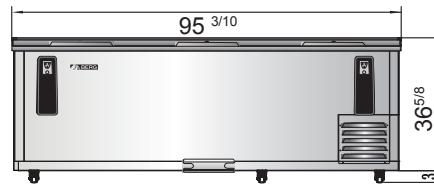
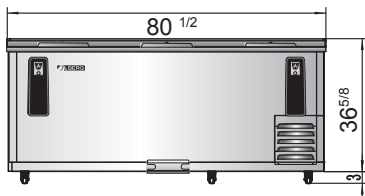

Bottle Opener & Cap Catcher

Stainless Steel Lids

Wire Dividers

